



## SC FIBER OPTIC ADAPTERS

### Description

Pacific interconnections' SC\* adapter has a plastic housing and either a precision zirconia or a rugged phosphor bronze sleeve. Zirconia sleeve enables stable connection and thus enhances performance, and is ideal for single mode applications. Phosphor bronze sleeve provides durability, and is ideal for multimode applications. Flange-mount type simplex and duplex adapters are available.

\*SC is a trademark of NTT Advanced Technology Corp.

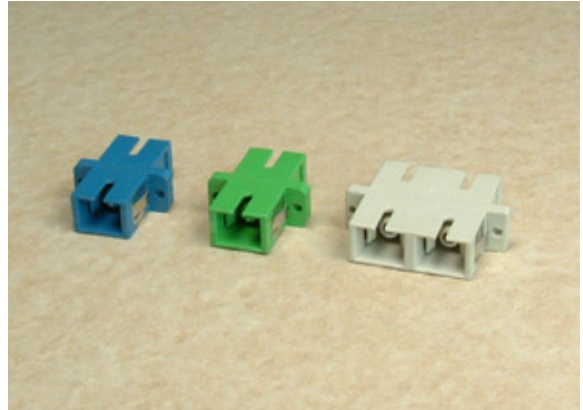

### Features

- Low insertion loss
- Good exchangeability and repeatability
- Zirconia or phosphor-bronze sleeve
- Simplex or duplex
- Flange mount style

### Applications

- Telecommunication
- Computer networks
- CATV networks
- Active device termination
- Instrumentation

### Specifications

Characteristics	Unit	Single Mode	Multimode
Insertion Loss (IL)	dB	$\leq 0.3$	
Exchangeability	dB	$\Delta IL \leq 0.2$	
Repeatability (500 remates)	dB	$\Delta IL \leq 0.2$	
Sleeve material	-	Zirconia	Phosphor Bronze
Housing material	-	Plastic	
Operating Temperature	°C	-20 ~ +70	
Storage Temperature	°C	-40 ~ +70	

### Dimensional Drawing

#### Simplex

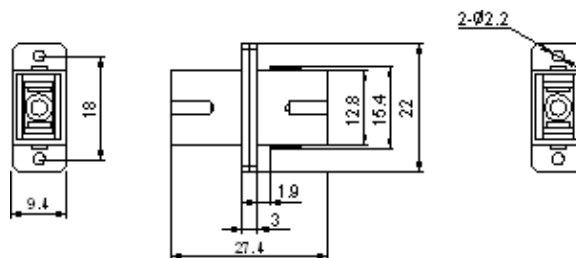

Unit in mm

## Dimensional Drawing

Duplex

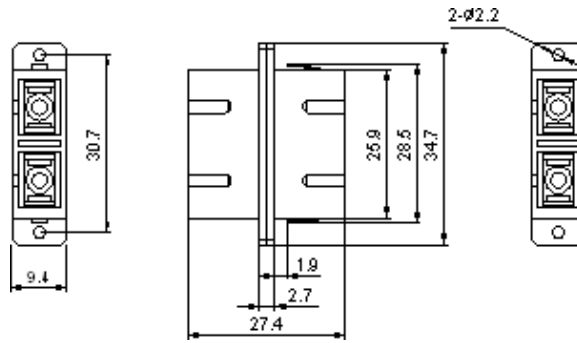

Unit in mm

## Ordering Information

Part Number: **ADA-S A S R F**

**1 2 3 4**

- |          |                  |                               |
|----------|------------------|-------------------------------|
| <b>1</b> | Connector Type   | S=SC                          |
| <b>2</b> | Connector Finish | P=PC, A=APC                   |
| <b>3</b> | Fiber Count      | S=Simplex, D=Duplex           |
| <b>4</b> | Sleeve Material  | R=Zirconia, K=Phosphor Bronze |

Products manufactured in  
ISO 9001 certified facilities



Pacific Interconnections • [www.pacificinterco.com](http://www.pacificinterco.com) • 425-2779527

We reserve the rights to make any changes to the product(s) or information contained herein without notice. No liability is assumed.