

FIBER OPTIC ADAPTERS

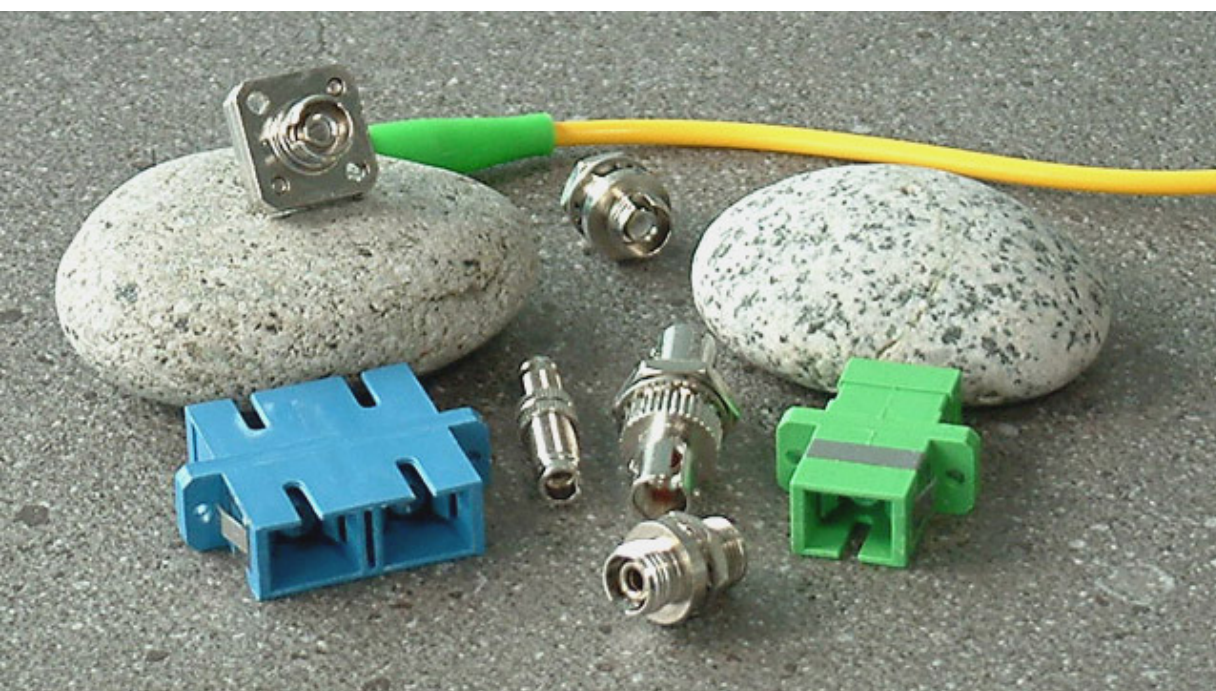

SC, FC, ST, DIN, SC-FC, SC-ST, FC-ST, etc.



PACIFIC
INTERCONNECTIONS
- connecting the world with fiber optics



SC FIBER OPTIC ADAPTERS

Description

Pacific interconnections' SC* adapter has a plastic housing and either a precision zirconia or a rugged phosphor bronze sleeve. Zirconia sleeve enables stable connection and thus enhances performance, and is ideal for single mode applications. Phosphor bronze sleeve provides durability, and is ideal for multimode applications. Flange-mount type simplex and duplex adapters are available.

*SC is a trademark of NTT Advanced Technology Corp.

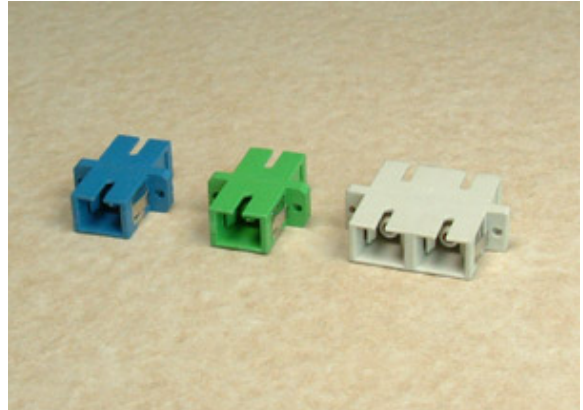

Features

- Low insertion loss
- Good exchangeability and repeatability
- Zirconia or phosphor-bronze sleeve
- Simplex or duplex
- Flange mount style

Applications

- Telecommunication
- Computer networks
- CATV networks
- Active device termination
- Instrumentation

Specifications

Characteristics	Unit	Single Mode	Multimode
Insertion Loss (IL)	dB	≤ 0.3	
Exchangeability	dB	$\Delta IL \leq 0.2$	
Repeatability (500 remates)	dB	$\Delta IL \leq 0.2$	
Sleeve material	-	Zirconia	Phosphor Bronze
Housing material	-	Plastic	
Operating Temperature	°C	-20 ~ +70	
Storage Temperature	°C	-40 ~ +70	

Dimensional Drawing

Simplex

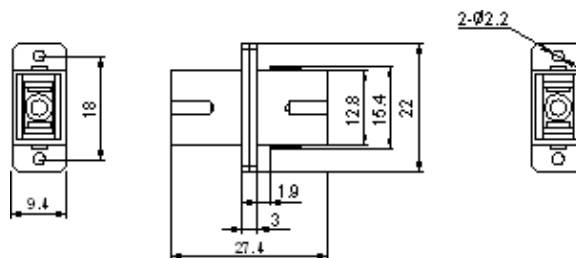

Unit in mm

Dimensional Drawing

Duplex

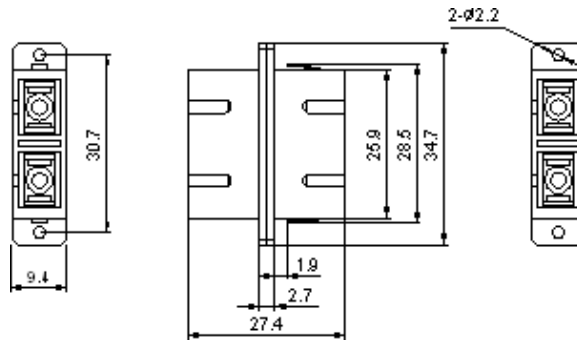

Unit in mm

Ordering Information

Part Number: **ADA-S A S R F**

1 2 3 4

1 Connector Type	S=SC
2 Connector Finish	P=PC, A=APC
3 Fiber Count	S=Simplex, D=Duplex
4 Sleeve Material	R=Zirconia, K=Phosphor Bronze

Products manufactured in
ISO 9001 certified facilities



Pacific Interconnections • www.pacificinterco.com • 425-2779527

We reserve the rights to make any changes to the product(s) or information contained herein without notice. No liability is assumed.



FC FIBER OPTIC ADAPTERS

Description

Pacific interconnections' FC* adapter has a metal housing and either a precision zirconia or a rugged phosphor bronze sleeve. Zirconia sleeve enables stable connection and thus enhances performance, and is ideal for single mode applications. Phosphor bronze sleeve provides durability, and is ideal for multimode applications. Square flange mount and "D" hole mount styles are available.

*FC is a trademark of NTT Advanced Technology Corp.



Features

- Low insertion loss
- Good exchangeability and repeatability
- Zirconia or phosphor bronze sleeve
- Square flange or "D" hole mount style

Applications

- Telecommunication
- Computer networks
- CATV networks
- Active device termination
- Instrumentation

Specifications

Characteristics	Unit	Single Mode	Multimode
Insertion Loss (IL)	dB	≤ 0.3	
Exchangeability	dB	$\Delta IL \leq 0.2$	
Repeatability (500 remates)	dB	$\Delta IL \leq 0.2$	
Sleeve material	-	Zirconia	Phosphor bronze
Housing material	-	Nickel plated Copper	
Operating Temperature	°C	-40 ~ +70	
Storage Temperature	°C	-40 ~ +70	

Dimensional Drawing

Square Flange

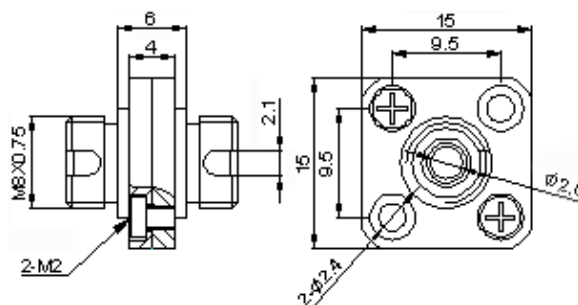

Unit in mm

Dimensional Drawing

D-Hole

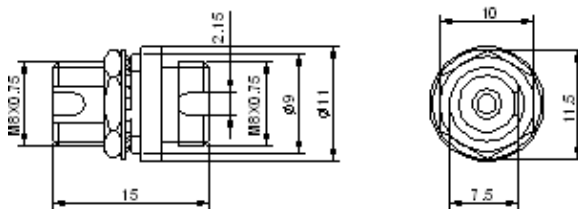

Unit in mm

DD-Hole

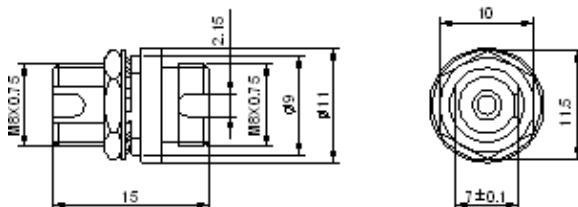

Unit in mm

Ordering Information

Part Number: **ADA-F A S R S**

1 2 3 4

- | | | |
|----------|------------------|--------------------------------------|
| 1 | Connector Type | F=FC |
| 2 | Connector Finish | P=PC, A=APC |
| 3 | Sleeve Material | R=Zirconia, K=Phosphor bronze |
| 4 | Mounting Style | S=Square Flange, D=D Hole, E=DD-Hole |

Products manufactured in ISO 9001 certified facilities



Pacific Interconnections • www.pacificinterco.com • 425-2779527

We reserve the rights to make any changes to the product(s) or information contained herein without notice. No liability is assumed.



ST FIBER OPTIC ADAPTERS

Description

Pacific interconnections' ST* adapter has a metal housing and either a precision zirconia or a rugged phosphor bronze sleeve. Zirconia sleeve enables stable connection and thus enhances performance, and is ideal for single mode applications. Phosphor bronze sleeve provides durability, and is ideal for multimode applications. "D" hole mount style is available.

*ST is a trademark of Lucent Technologies



Features

- Low insertion loss
- Good exchangeability and repeatability
- Zirconia or phosphor bronze sleeve
- "D" hole mount style

Applications

- Local Area Networks
- Fast Ethernet
- Fiber Channel
- ATM Networks

Specifications

Characteristics	Unit	Single Mode	Multimode
Insertion Loss (IL)	dB	≤ 0.3	
Exchangeability	dB	$\Delta IL \leq 0.2$	
Repeatability (500 remates)	dB	$\Delta IL \leq 0.2$	
Sleeve material	-	Zirconia	Phosphor Bronze
Housing material	-	Zinc Aluminum Alloy	
Operating Temperature	°C	-40 ~ +70	
Storage Temperature	°C	-40 ~ +70	

Dimensional Drawing

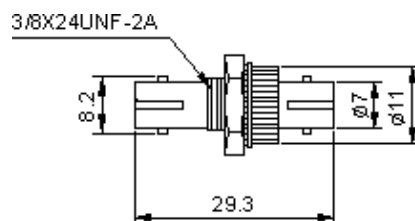

Unit in mm

Ordering Information

Part Number: **ADA-T P S R D**

1 **2**

- 1** Connector Type T=ST
- 2** Sleeve Material R=Zirconia, K=Phosphor Bronze

Products manufactured in
ISO 9001 certified facilities



Pacific Interconnections • www.pacificinterco.com • 425-2779527

We reserve the rights to make any changes to the product(s) or information contained herein without notice. No liability is assumed.



DIN FIBER OPTIC ADAPTERS

Description

Pacific interconnections' DIN adapter has a metal housing and either a precision zirconia or a rugged phosphor bronze sleeve. Zirconia sleeve enables stable connection and thus enhances performance, and is ideal for single mode applications. Phosphor bronze sleeve provides durability, and is ideal for multimode applications. "D" hole mount style is available.



Features

- Low insertion loss
- Good exchangeability and repeatability
- Zirconia or phosphor bronze sleeve
- "D" hole mount style

Applications

- Telecommunication
- Computer networks
- CATV networks
- Instrumentation

Specifications

Characteristics	Unit	Single Mode	Multimode
Insertion Loss (IL)	dB	≤ 0.3	
Exchangeability	dB	$\Delta IL \leq 0.2$	
Repeatability (500 remates)	dB	$\Delta IL \leq 0.2$	
Sleeve material	-	Zirconia	Phosphor bronze
Housing material	-	Nickel plated Copper	
Operating Temperature	°C	-40 ~ +70	
Storage Temperature	°C	-40 ~ +70	

Dimensional Drawing

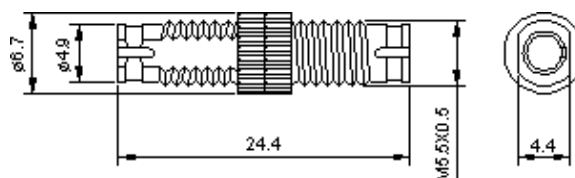

Unit in mm

Ordering Information

Part Number: **ADA-DN A S R D**

1 2 3

1 Connector Type	DN=DIN
2 Connector Finish	P=PC, A=APC
3 Sleeve Material	R=Zirconia, K=Phosphor bronze

Products manufactured in
ISO 9001 certified facilities



Pacific Interconnections • www.pacificinterco.com • 425-2779527

We reserve the rights to make any changes to the product(s) or information contained herein without notice. No liability is assumed.



SC-FC FIBER OPTIC ADAPTERS

Description

Pacific interconnections' SC*-FC* adapter provides interconnectivity between SC and FC connectors. It has a metal housing and either a precision zirconia or a rugged phosphor bronze sleeve. Zirconia sleeve enables stable connection and thus enhances performance, and is ideal for single mode applications. Phosphor bronze sleeve provides durability, and is ideal for multimode applications. Square flange mount and flange mount styles are available.

*SC and FC are trademarks of NTT Advanced Technology Corp.



Features

- Low insertion loss
- Good exchangeability and repeatability
- Zirconia or bronze sleeve
- Square flange or flange mount style

Applications

- Telecommunication
- Instrumentation
- CATV networks
- Computer networks

Specifications

Characteristics	Unit	Single Mode	Multimode
Insertion Loss (IL)	dB	≤0.3	
Exchangeability	dB	ΔIL≤0.2	
Repeatability (500 remates)	dB	ΔIL≤0.2	
Sleeve material	-	Zirconia	Phosphor Bronze
Housing material	-	Aluminum-Zinc Alloy	
Operating Temperature	°C	-40 ~ +70	
Storage Temperature	°C	-40 ~ +70	

Dimensional Drawing

Square Flange

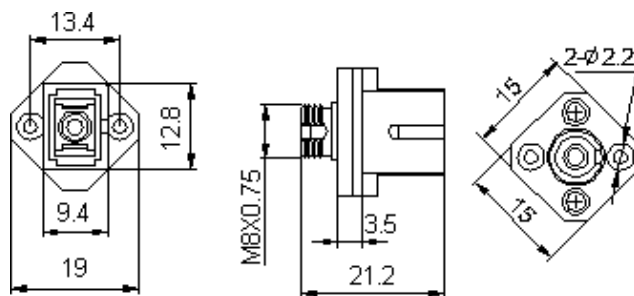

Unit in mm

Dimensional Drawing

Flange

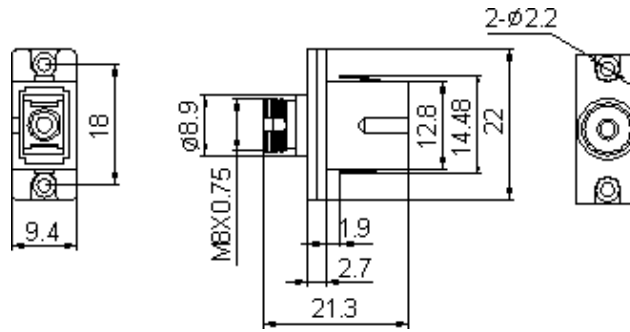

Unit in mm

Ordering Information

Part Number: **ADA-S F R S**
1 2 3 4

- | | |
|---|-------------------------------|
| 1 Connector Type #1 | S=SC |
| 2 Connector Type #2 | F=FC |
| 3 Sleeve Material | R=Zirconia, K=Phosphor Bronze |
| 4 Mounting Style | S=Square Flange, F=Flange |

Products manufactured in
ISO 9001 certified facilities



Pacific Interconnections • www.pacificinterco.com • 425-2779527

We reserve the rights to make any changes to the product(s) or information contained herein without notice. No liability is assumed.



SC-ST FIBER OPTIC ADAPTERS

Description

Pacific interconnections' SC*-ST* adapter provides interconnectivity between SC and ST connectors. It has a metal housing and either a precision zirconia or a rugged phosphor bronze sleeve. Zirconia sleeve enables stable connection and thus enhances performance, and is ideal for single mode applications. Phosphor bronze sleeve provides durability, and is ideal for multimode applications. Flange mount style is available.

*SC is a trademark of NTT Advanced Technology Corp.
*ST is a trademark of Lucent Technologies



Features

- Low insertion loss
- Good exchangeability and repeatability
- Zirconia or bronze sleeve
- Flange mount style

Applications

- Local Area Networks
- Fast Ethernet
- Fiber Channel
- Instrumentation

Specifications

Characteristics	Unit	Single Mode	Multimode
Insertion Loss (IL)	dB	≤ 0.3	
Exchangeability	dB	$\Delta IL \leq 0.2$	
Repeatability (500 remates)	dB	$\Delta IL \leq 0.2$	
Sleeve material	-	Zirconia	Phosphorus Bronze
Housing material	-	Aluminum-Zinc Alloy	
Operating Temperature	°C	-40 ~ +70	
Storage Temperature	°C	-40 ~ +70	

Dimensional Drawing

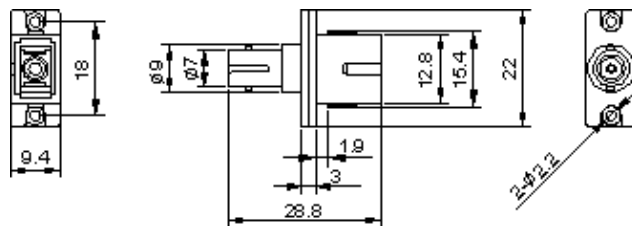

Unit in mm

Ordering Information

Part Number: **ADA-S T S K F**

1 2 3

- | | |
|----------------------------|---------------------------------|
| 1 Connector Type #1 | S=SC |
| 2 Connector Type #2 | T=ST |
| 3 Sleeve Material | R=Zirconia, K=Phosphorus Bronze |

Products manufactured in
ISO 9001 certified facilities



Pacific Interconnections • www.pacificinterco.com • 425-2779527

We reserve the rights to make any changes to the product(s) or information contained herein without notice. No liability is assumed.



FC-ST FIBER OPTIC ADAPTERS

Description

Pacific interconnections' FC*-ST* adapter provides interconnectivity between FC and ST connectors. It has a metal housing and either a precision zirconia or a rugged phosphor bronze sleeve. Zirconia sleeve enables stable connection and thus enhances performance, and is ideal for single mode applications. Phosphor bronze sleeve provides durability, and is ideal for multimode applications. Flange mount and "D" hole mount styles are available.

*FC is a trademark of NTT Advanced Technology Corp.
*ST is a trademark of Lucent Technologies



Features

- Low insertion loss
- Good exchangeability and repeatability
- Zirconia or phosphor bronze sleeve
- Flange or "D" hole mount style

Applications

- Instrument
- Computer networks
- CATV networks

Specifications

Characteristics	Unit	Single Mode	Multimode
Insertion Loss (IL)	dB	≤ 0.3	
Exchangeability	dB	$\Delta IL \leq 0.2$	
Repeatability (500 remates)	dB	$\Delta IL \leq 0.2$	
Sleeve material	-	Zirconia	Phosphor Bronze
Housing material	-	Aluminum-Zinc Alloy	
Operating Temperature	°C	-40 ~ +70	
Storage Temperature	°C	-40 ~ +70	

Dimensional Drawing

Flange

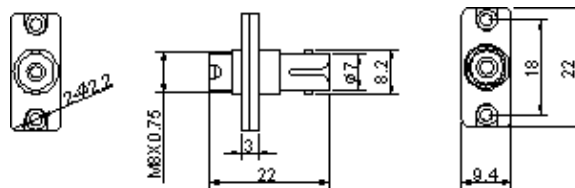

Unit in mm

Dimensional Drawing

D-Hole

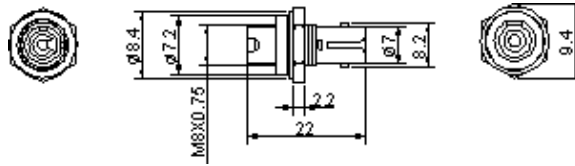

Unit in mm

Ordering Information

Part Number: **ADA-F T S R F**

1 2 3 4

- | | | |
|----------|-------------------|-------------------------------|
| 1 | Connector Type #1 | F=FC |
| 2 | Connector Type #2 | T=ST |
| 3 | Sleeve Material | R=Zirconia, K=Phosphor Bronze |
| 4 | Mounting Style | F=Flange, D=D Hole |

Products manufactured in
ISO 9001 certified facilities



Pacific Interconnections • www.pacificinterco.com • 425-2779527

We reserve the rights to make any changes to the product(s) or information contained herein without notice. No liability is assumed.